



- This appliance can be used by children aged from 8 years and above and persons with reduced physical, sensory or mental capabilities or lack of experience and knowledge if they have been given supervision or instruction concerning use of the appliance in a safe way and understand the hazards involved. Cleaning and user maintenance shall not be made by children without supervision. Children shall not play with the appliance.
- Before operation, please confirm whether power specifications comply with the specifications of the appliance (see technical data).
- Before cleaning or maintaining the air conditioner, please turn off air conditioner and pull out the power plug.
- Make sure the power cord hasn't been pressed by hard objects.
- Do not pull or drag the power cord to pull out the power plug or move the air conditioner.
- Do not insert or pull out the power plug with wet hands.
- Please use the grounded power. Make sure the grounding is reliable.
- If the supply cord is damaged, it must be replaced by the manufacturer or its service agent or a similarly qualified person in order to avoid a hazard.
- Never cover the air conditioner with a towel or anything similar. Keep air inlet and air outlet clear of obstacles.
- Keep a distance of at least 12" (30 cm) to walls and obstacles.
- If abnormal condition occurs (e.g. burned smell), please disconnect power at once and then contact local dealer.
- When nobody is taking care of the unit, please turn it off and disconnect power.
- Do not splash or pour water on air conditioner or the remote control, as this may damage them.
- If drainage hose is used, ambient temperature can't be lower than 0° C. Otherwise, it will cause water leakage to air conditioner.
- Far away from fire source, inflammable and explosive objects.
- Children and disabled people are not allowed to use the unit without supervision.
- Keep children from playing or climbing on the air conditioner.
- Do not put or hang dripping objects above the air conditioner.
- Do not repair or disassemble the air conditioner by yourself.
- Prohibit inserting any objects into the air conditioner.
- The appliance must be positioned so that the plug is accessible.
- Never incline or turn the air conditioner over.



- Make sure the appliance is operated on a stable and level underground.
- Avoid exposing the appliance to direct sunlight.
- The air conditioner must only be operated within the temperature range of 16° to 35° C.
- Close doors and windows when operating the appliance to improve the cooling effect.
- Do not operate the appliance in wet or humid environments.
- Make sure there are no obstacles between the appliance and the remote control. Don't drop or throw the remote control. Don't submerge the remote control in any liquid, don't expose it to heat or direct sunlight.
- Dispose batteries correctly. Pay attention to environmental aspects when disposing of batteries. Do not dispose of with household waste.
- Observe the safety notes and other notes on the battery and its packaging.
- Remove leaking batteries and clean the battery compartment thoroughly. Avoid contact with eyes and skin.

Use of batteries:

- CAUTION! Explosion hazard when the batteries are not replaced correctly. Only replace by batteries of the same type. Pay attention to the correct polarity.
- Do not expose batteries (battery pack or inserted batteries) to excessive heat from sunlight, fire, etc. Protect from mechanical shocks. Keep dry and clean. Keep out of reach of children.
- Do not open, disassemble, cut open, or short-circuit batteries. Do not use old and new batteries together.

Intended use

This appliance is intended only for cooling, blowing and dehumidifying air. The appliance is intended for use in households or similar non-commercial areas like shops, offices, and similar work environments, or in agricultural establishments, by customers in hotels, motels, and other typical residential accommodation or in bed and breakfast accommodation. Only use according to these instructions. Improper use is dangerous and will void any warranty claim. Observe the safety instructions.

Disposal



The crossed-out wheeled bin symbol requires separate disposal for waste electrical and electronic equipment (WEEE). Electrical and electronic appliances can contain dangerous and environment-hazardous substances. Do not dispose of this appliance and its packaging in unsorted household waste. Dispose at a registered collection center for waste electrical and electronic equipment. In this way, you contribute to protection of resources and the environment. For further information, please contact your dealer or the local authorities.



Dispose of used batteries correctly. Containers for old batteries are located in shops selling batteries and at city collection points.

Used symbols



Indicates a hazardous situation that could lead to injury or material damage.



Please read all instructions carefully before using the appliance, and keep the operating instructions for later use.

Explanation of Symbols



Indicates a hazardous situation that, if not avoided, will result in death or serious injury.



Indicates a hazardous situation that, if not avoided, could result in death or serious injury.



Indicates a hazardous situation that, if not avoided, may result in minor or moderate injury.

NOTICE

Indicates important but not hazard-related information, used to indicate risk of property damage.



Indicates a hazard that would be assigned a signal word WARNING or CAUTION.



Appliance filled with flammable gas R32.



Before install and use the appliance, read the owner's manual first.



Before repair the appliance, read the service manual first.

The Refrigerant

- To realize the function of the air conditioner unit, a special refrigerant circulates in the system. The used refrigerant is the fluoride R32, which is specially cleaned. The refrigerant is flammable and inodorous. Furthermore, it can lead to explosion under certain conditions. But the flammability of the refrigerant is very low. It can be ignited only by fire.
- Compared to common refrigerants, R32 is a nonpolluting refrigerant with no harm to the ozone layer. The influence upon the greenhouse effect is also lower. R32 has got very good thermodynamic features which lead to a really high energy efficiency. The units therefore need a less filling.

WARNING:

Do not use means to accelerate the defrosting process or to clean, other than those recommended by the manufacturer. Should repair be necessary, contact your nearest authorized Service Centre. Any repairs carried out by unqualified personnel may be dangerous. The appliance shall be stored in a room without continuously operating ignition sources. (for example: open flames, an operating gas appliance or an operating electric heater.) Do not pierce or burn.

Appliance shall be installed, operated and stored in a room with a floor area larger than 4m².

Appliance filled with flammable gas R32. For repairs, strictly follow manufacturer's instructions only. Be aware that refrigerants do not contain odour. Read specialist's manual.

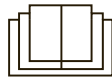

DEAR CUSTOMER _____

Congratulation on the purchase of your mobile air conditioner. Please take the time to read these operating instructions. Keep them at a safe place for future reference and possibly hand them over together with the appliance.

TABLE OF CONTENT _____

Safety Instructions	26	Installation	42
Intended use	28	Installation safety instructions	42
Disposal	28	Accessories	43
Used symbols	28	Installing water drainage	44
Electric schematic diagram	31	Heat discharge pipe	46
Overview	32	Operation test	47
Operation	33	Technical data	47
Cleaning and Maintenance	39	Window installation	48
Troubleshooting	40		

ELECTRIC SCHEMATIC DIAGRAM _____

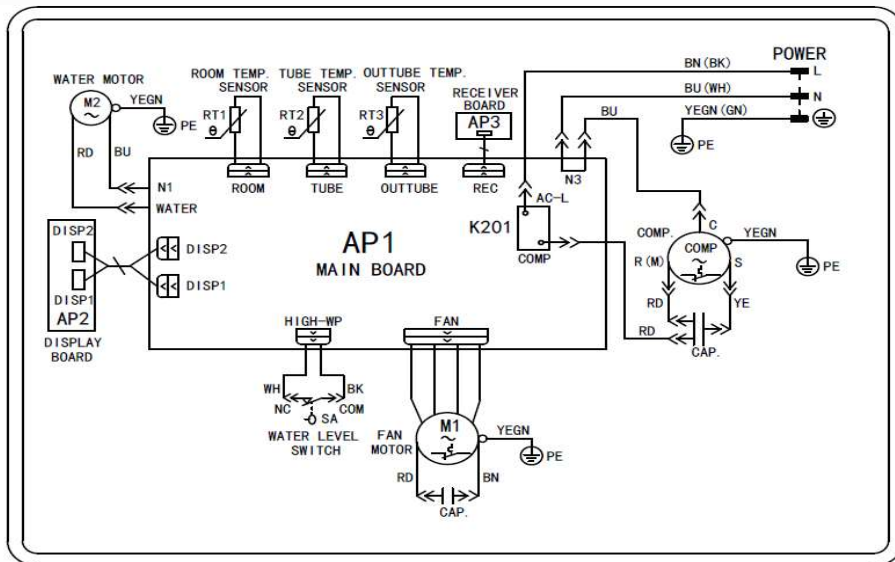

OVERVIEW

Air conditioner

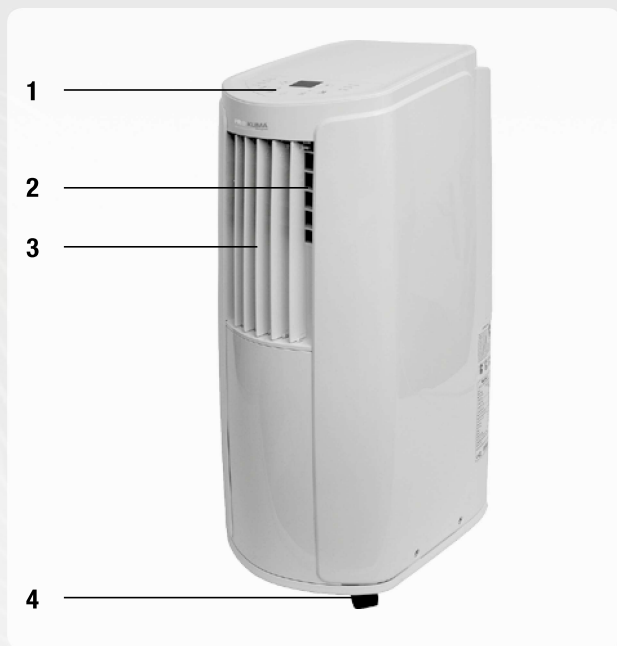

- 1 Control panel
- 2 Guide grille
- 3 Swing grille
- 4 Caster
- 5 Filter cover
- 6 Air inlet
- 7 Fixing clasp
- 8 Middle drainage hole
- 9 Groove for heat discharge pipe
- 10 Power cable
- 11 Lower drainage hole
- 12 Remote control
- 13 2x AAA1.5V Batteries

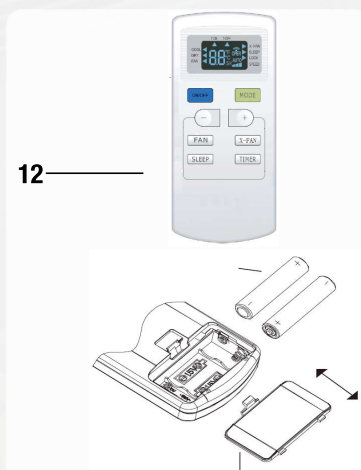
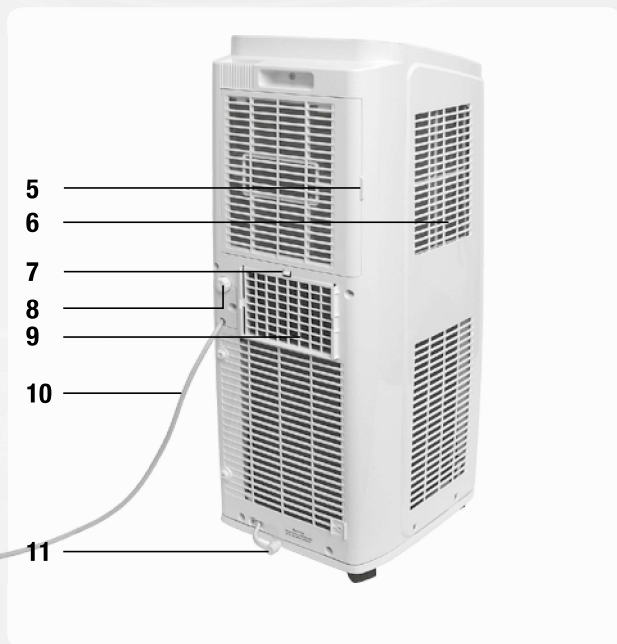

Inserting batteries

Open the battery compartment, insert AAA1.5V batteries and replace the cover. Pay attention to the polarity markings!

Control panel (1)

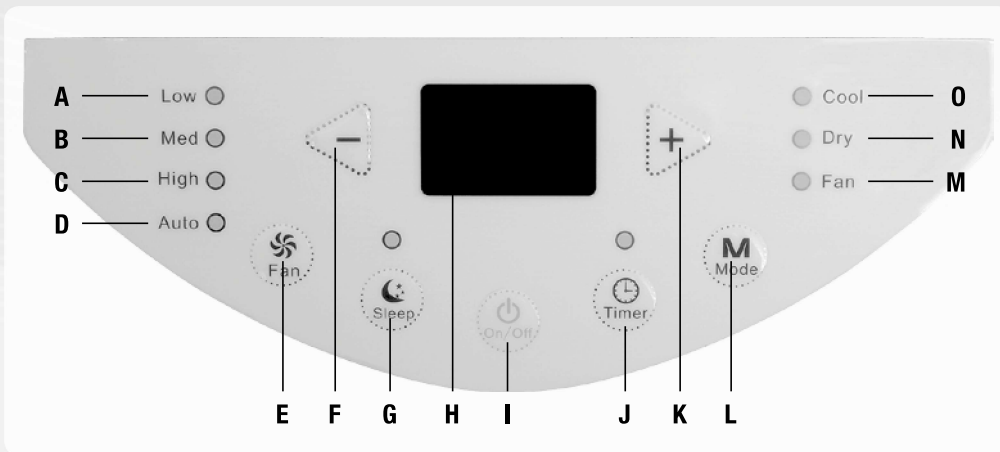

- A** Low speed indicator
- B** Medium speed indicator
- C** High speed indicator
- D** Automatic indicator
- E** Fan button
- F** - button
- G** Sleep button

- H** Display control panel
- I** On/Off button
- J** Timer button
- K** + button
- L** Mode button
- M** Fan mode indicator
- N** Dry mode indicator
- O** Cool mode indicator

Buttons on Remote Controller



- ① ON/OFF button
- ② MODE button
- ③ +/- button
- ④ FAN button
- ⑤ X-FAN button
- ⑥ SLEEP button
- ⑦ TIMER button

Introduction for Icons on Display Screen

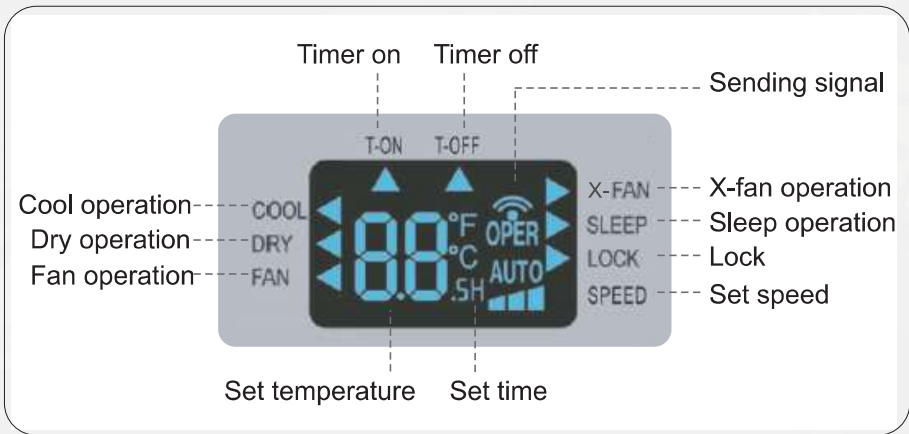

Introduction for Buttons on Remote Controller

Note:

- This is a general use remote controller, it could be used for the air conditioners with multifunction; For some function, which the model doesn't have, if press the corresponding button on the remote controller that the unit will keep the original running status.
- After putting through the power, the air conditioner will give out a sound. Operation indicator "⏻" is ON (red indicator). After that, you can operate the air conditioner by using remote controller.
- Under on status, pressing the button on the remote controller, the signal icon "📶" on the display of remote controller will blink once and the air conditioner will give out a "de" sound, which means the signal has been sent to the air conditioner.
- Under off status, set temperature and clock icon will be displayed on the display of remote controller (If timer on, timer off and light functions are set, the corresponding icons will be displayed on the display of remote controller at the same time); Under on status, the display will show the corresponding set function icons.

1 ON/OFF button

Press this button to turn unit on/off.

2 MODE button

Pressing this button once can select your required mode circularly as below (the corresponding icon "◀" will be lit up after the mode is selected):



- When selecting cool mode, air conditioner will operate under cool mode. Then press + or - button to adjust set temperature. Press FAN button to adjust fan speed.
- When selecting dry mode, air conditioner will operate at low fan speed under dry mode. In dry mode, fan speed can't be adjusted.
- When selecting fan mode, air conditioner will operate in fan mode only. Then press FAN button to adjust fan speed.

3 + / - button

- Pressing + or - button once will increase or decrease set temperature by 1°F(°C). Holding + or - button for 2s, set temperature on remote controller will change quickly. Release the button after your required set temperature is reached.
- When setting Timer On or Timer Off, press + or - button to adjust the time. (See TIMER Button for setting details)

Introduction for Buttons on Remote Controller

4 FAN button

Pressing this button can select fan speed circularly as: AUTO, SPEED 1 (▲), SPEED 2 (▲▲), SPEED 3 (▲▲▲).

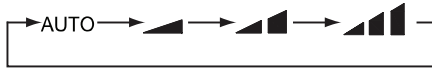

Note:

- Under Auto speed, air conditioner will select proper fan speed automatically according to ambient temperature.
- Fan speed can't be adjusted under Dry mode.

5 X-FAN button

Press this button under cool and dry mode to start up x-fan function. Press this button again to cancel x-fan function.

Note:

- When x-fan function is on, if the air conditioner is turned off, indoor fan will still operate at low speed for a while to blow the residual water inside the air duct.
- During x-fan operation, press X-FAN button to turn off x-fan function. Indoor fan will stop operation immediately.

6 SLEEP button

Under Cool mode, press this button to turn on Sleep function. Press this button to cancel Sleep function. Under Fan mode, this function is unavailable.

7 TIMER button

- When unit is on, press this button to set Timer Off. T-OFF and H icon will be blinking. Within 5s, press + or - button to adjust the time for Timer Off. Pressing + or - button once will increase or decrease the time by 0.5h. Holding + or - button for 2s, time will change quickly. Release the button after your required set time is reached. Then press TIMER button to confirm it. T-OFF and H icon will stop blinking.
- When unit is off, press this button to set Timer On. T-ON and H icon will be blinking. Within 5s, press + or - button to adjust the time for Timer On. Pressing + or - button once will increase or decrease the time by 0.5h. Holding + or - button for 2s, time will change quickly. Release the button after your required set time is reached. Then press TIMER button to confirm it. T-ON and H icon will stop blinking.
- Cancel Timer On/Off: If Timer function is set up, press TIMER button once to review the remaining time. Within 5s, press TIMER button again to cancel this function.

Introduction for Buttons on Remote Controller

Note:

- Timer setting range: 0.5~24h
- The interval between two motions can't exceed 5s, otherwise the remote controller will exit setting status.

Function Introduction for Combination Buttons

Child lock function

Pressing "+" and "-" buttons simultaneously can turn on or turn off child lock function. When child lock function is started up, LOCK indicator on remote controller is ON. If you operate the remote controller, remote controller won't send signal.

Temperature display switchover function

Under OFF status, pressing "-" button and "MODE" button simultaneously can switch between °C and °F.

Light function

Under switch-on or switch-off state, you may hold "+" and "FAN" buttons simultaneously for 3 seconds to set the lamp on or off and send the code. After being energized the lamp is defaulted on.

Operation Guide

1. After putting through the power, press "ON/OFF" button on remote controller to turn on the air conditioner.
2. Press "MODE" button to select your required mode: COOL, DRY, FAN.
3. Press "+" or "-" button to set your required temperature. (Temperature can't be adjusted under auto mode).
4. Press "FAN" button to set your required fan speed: auto, low, medium and high speed.

Replacement of Batteries in Remote Controller

1. Press the back side of remote controller on the spot marked with "", and then push out the cover of battery box along the arrow direction.
2. Replace two No.7 (AAA 1.5V) dry batteries and make sure the positions of + and - polar are correct.
3. Reinstall the cover of battery box.

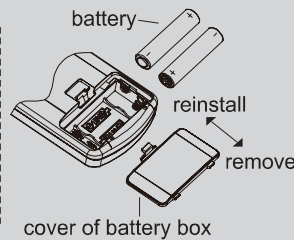

NOTICE

- During operation, point the remote control signal sender at the receiving window on the unit.
- The distance between signal sender and receiving window should be no more than 8m, and there should be no obstacles between them.
- Signal may be interfered easily in the room where there is fluorescent lamp or wireless telephone; remote controller should be close to the unit during operation.
- Replace new batteries of the same model when replacement is required.
- When you don't use remote controller for a long time, please take out the batteries.
- If the display on remote controller is fuzzy or there's no display, please replace batteries.

CLEANING AND MAINTENANCE



Warning:

Before cleaning the air conditioner, always switch off the device and disconnect the power. Danger of electric shock!



Outer case and grille

Clean outer case with a soft cloth. If necessary use neutral cleaning agent to wipe it. Never use volatile liquids or scouring powders. Clean the grille with a soft brush.

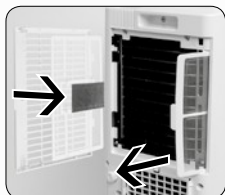

Clean filter

Open the cover and remove the filters. Clean the filters with warm water and neutral cleaning agent. Let it dry thoroughly before reinserting it. Do not expose to heat to avoid deforming.

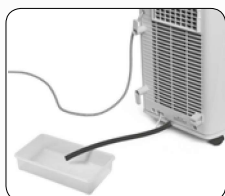
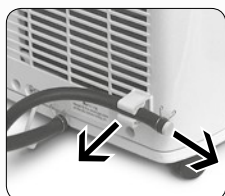

Removing collected water

When using the drainage from the bottom hole (see Installation):

- Take the drainage pipe from the clip and pull out the plug.
- Discharge the collected water into a suitable container, put back the plug into the drainage pipe and fix the pipe on the clip.
- Wait for approx. 3 minutes before restarting the device.

Caution: Do not tilt the device, keep it always horizontal.

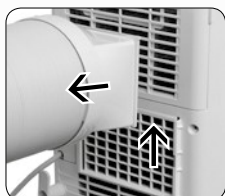
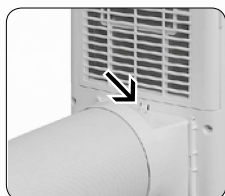

Clean heat discharge pipe

Push the fixing clasp back and pull joint **c** out of the groove. Remove the pipe, clean it and let it dry thoroughly before reinstalling it.

TROUBLESHOOTING

Problem	Possible cause	Solution
Device does not operate	Power failure	Check the power supply
	Plug loose	Insert the plug properly
	Device restarted too quickly after stopping	Wait for 3 minutes before turning the device back on again
Poor performance	Power too low	Check the power supply
	Air filter dirty	Clean air filter
	Set temperature is not proper	Adjust temperature setting
	Door or windows are open	Close doors and windows
Device can not be controlled by remote control	Serious interference (static pressure, unstable voltage)	Pull the plug, wait for 3 min, reinsert it and restart the device
	Remote control is outside receiving range	Do not exceed the receiving range of 8 m
	Blocked by obstacles	Remove any obstacles between device and remote control
	Battery low	Check the batteries of remote control and replace if necessary
	There is a fluorescence lamp in the room	Turn off the fluorescence lamp and try again Try with the remote control close to the device
No air coming out	Blocked air inlet or air outlet	Remove any obstacles
	Device is defrosting (check by pulling out filter)	The device will resume operation after defrosting
Temperature can not be adjusted	Required temperature exceeds the setting range	Stay within the setting range of 16° C to 30° C
	Device operates in auto mode	Change the mode
Abnormal smell	Filter is dirty	Clean the filter
Abnormal sounds	Interferences by radio, thunder, etc.	Pull the plug, wait for 3 min, reinsert it and restart the device
„PAPA“ sound	Friction sound that can be caused by the change of temperature	
Water flowing sounds	A flowing sound of the refrigerant inside the device is normal	

If the problem persists, please switch off the device, disconnect the power immediately and contact the service center.

Malfunction code	Cause	Solution
H8	Chassis is full of water	<ul style="list-style-type: none"> • Remove the water. • If malfunction persists, please contact service center
F1	Malfunction of ambient temperature sensor	Please contact service center
F2	Malfunction of evaporator temperature sensor	Please contact service center
F0	Refrigerant is leaking System is blocked	<ul style="list-style-type: none"> • Pull the plug, wait for 30 min, reinsert it and restart the device • If malfunction persists, please contact service center
H3	Overloaded compressor	<ul style="list-style-type: none"> • Check ambient temperature and humidity. The ambient temperature should not exceed 35° C • Check if evaporator or condenser are blocked by objects. Remove any obstacles, pull the plug, wait for 3 min, reinsert it and restart the device • If malfunction persists, please contact service center
E8	Overload malfunction	
F4	Outdoor tube temperature sensor is open / short circuited	Please contact service center



Warning:

Turn off the air conditioner and disconnect the power immediately and contact the service center if the power cord is overheated or damaged, or there is a water leakage. Do not try to repair the device yourself! Danger of electric shock and fire!

Check after use:

Disconnect the power supply.
Clean filter and outer case.
Drain accumulated water in the chassis.

INSTALLATION SAFETY INSTRUCTIONS

- Keep away from strong heat sources, vapors, flammable, sulfuric or explosive gases.
- Keep away from high-frequency devices (such as welding machine, medical equipment).
- Do not operate the appliance in wet or humid environments.
- Keep obstacles away from air inlet and air outlet.
- Make sure that noise and air outflow do not affect the neighbourhood
- Keep away from fluorescent lamps.
- Do not operate the appliance in the laundry.
- Follow the national electric safety regulations when installing the appliance.
- If the supply cord is damaged, it must be replaced by the manufacturer, its service agent or similarly qualified persons in order to avoid a hazard. Never operate the appliance with a damaged supply cord.
- Always connect the appliance to a grounded socket.
- Be sure to cut off the power supply during installation and before cleaning and maintenance.



Installation location

When installing the air conditioner, keep a distance of at least 30 cm to walls and obstacles in all directions.

ACCESSORIES



- 1 Joint parts **a** and **b** and **c**
- 2 2x Cable hooks
- 3 3x Screws
- 4 Carbon filter
- 5 Drain hose adapter
- 6 Pipe clip
- 7 Pipe hoop
- 8 Rubber stopper
- 9 Drainage pipe
- 10 Heat discharge pipe

More accessories see „Window panel installation“

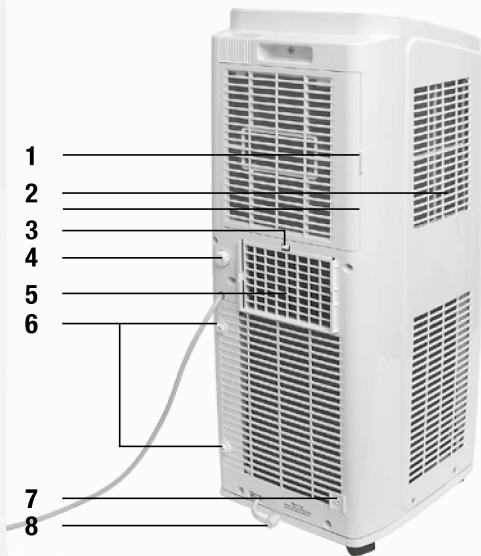

- 1 Filter cover
- 2 Air inlet
- 3 Middle drainage port
- 4 Fixing clasp
- 5 Groove for heat discharge pipe
- 6 Fixing points for cable fixing hooks
- 7 Fixing point for drainage pipe clip
- 8 Lower drainage port

Installation of cable hooks

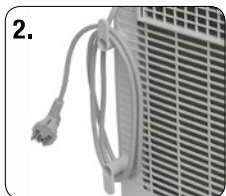
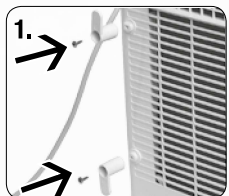

Fix the cable hooks to the fixating points with the screws as shown in picture 1.
Wind the power cable around the cable hooks as shown in picture 2.

INSTALLING WATER DRAINAGE

Use the drainage option at the bottom drainage port

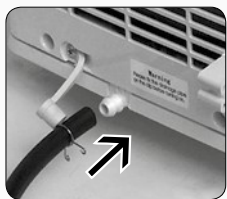
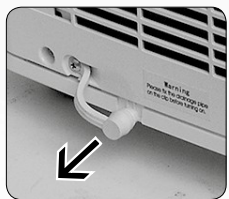

Remove the rubber plug from the drainage port.
Push the drainage pipe over the drainage port until the port is fully inserted in the pipe.



Secure the drainage pipe to the drainage port with the help of a pipe hoop.

Installing the pipe clip

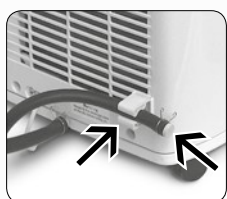

To fix the drainage pipe, attach the drainage pipe clip on the fixing point on the lower right backside with a screw.

Put the rubber stopper into the drainage pipe, secure it with the pipe hoop and fix the drainage pipe to the pipe clip.

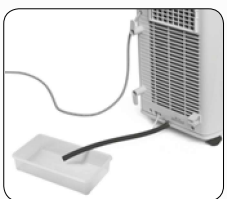
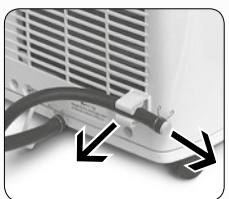

Removing collected water

When using the drainage from the bottom hole (see Installation):

- Take the drainage pipe from the clip and pull out the plug.
- Discharge the collected water into a suitable container, put back the plug into the drainage pipe and fix the pipe on the clip.
- Wait for approx. 3 minutes before restarting the device.

Caution: Do not tilt the device, keep it always horizontal.

Use the drainage option at the middle drainage port

The collected water can be automatically emptied from the middle drainage port into a floor drain by attaching a hose with an inner diameter of 14 mm (not included).

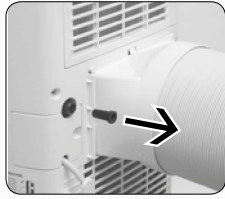
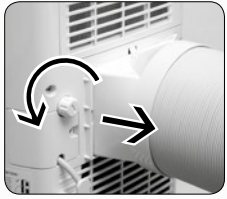

Remove the cap from the drainage port by turning it counter clockwise.

Remove the rubber stopper from the spout.

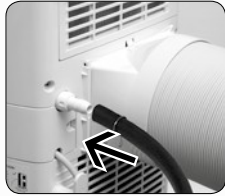
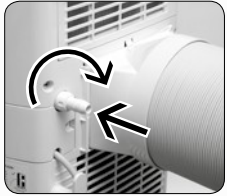

Screw the drain hose adapter to the port by turning it clockwise.

Push the drainage hose on to the adapter and secure it with a pipe hoop.

Attention:

Place the air conditioner on a level surface, make sure the hose is clear of any obstructions and pointing downward. Otherwise, not properly drained water might fill up the chassis and cause the device to shut off. If that should occur, empty the water in the chassis and check location and hose for proper setup.

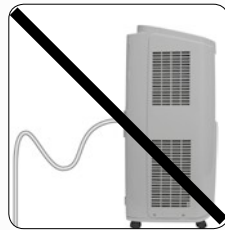
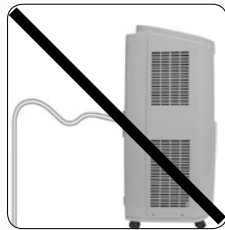
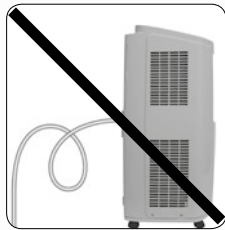
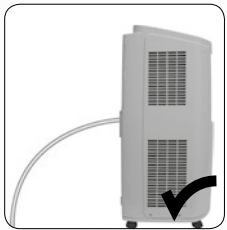

HEAT DISCHARGE PIPE

Install heat discharge pipe

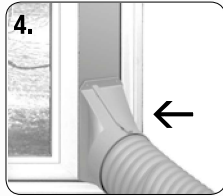
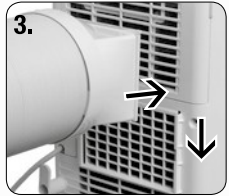
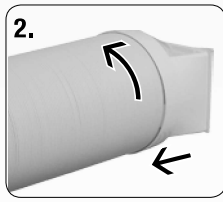
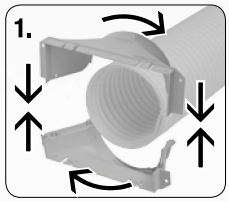

Assembly:

1. Connect joint **a** and **b** by pressing tightly. Observe the connecting points of **a** and **b**. Fix the joint on the heat discharge pipe by rotating gently clockwise.
2. Fix joint **c** on the other side of the heat discharging pipe by rotating gently clockwise.
3. Insert joint **c** with the „TOP“-side upwards into the groove until it clicks into place.

Installation

For efficient cooling, the heat discharge pipe should be kept as short and as curveless as possible to ensure a smooth heat discharge.

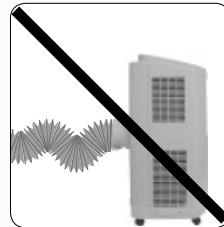
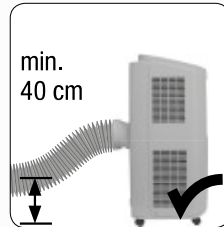
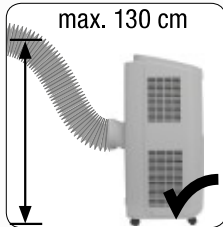
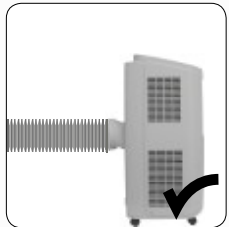

The length of the heat discharge pipe should not exceed 1 m.
When installing the appliance to a wall, make sure the outlet hole is about 40 cm to 130 cm from the floor.
Do not prolong it by connecting it with another heat discharge pipe.
Do not bend excessively, as this may cause malfunctioning.

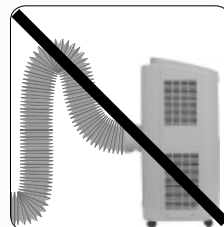

OPERATION TEST

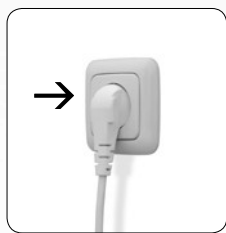

1. Plug the appliance into a wall outlet socket.
2. Press ON/OFF button on the remote control to start the appliance.
3. Press MODE button and select AUTO, COOL, DRY, and FAN and check if the appliance operates normally.

Note: If the ambient temperature is below 16° C, the appliance can not operate in cooling mode.

TECHNICAL DATA

	Model	GPC09AK-K6NNA1A
	Rated voltage	220-240 V ~
	Rated frequency	50 Hz
	Phases	1
	Rated input	1200 W
	Sound pressure level	5.3 / 5.1 / 4.9 dB(A)
	Max. allowable pressure	4.3 MPa
Cooling operation	ambient temperature range	16° C - 35° C
	Dimensions (WxHxD)	315 × 770 × 395
	Refrigerant	R32
	Refrigerant charge	0.35 kg
	Phases	1
	Phases	1

WINDOW PANEL INSTALLATION

Window panel installation accessories

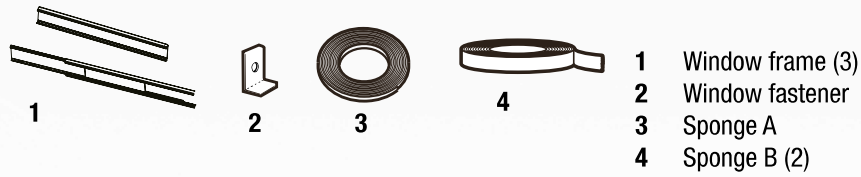

Optional accessories

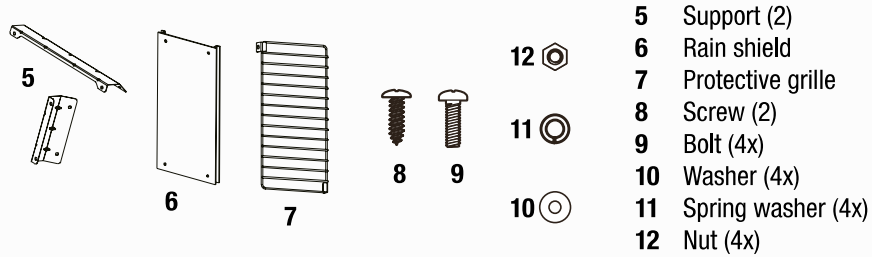

Installation in a sliding sash window of less than 20.5" (520 mm) height

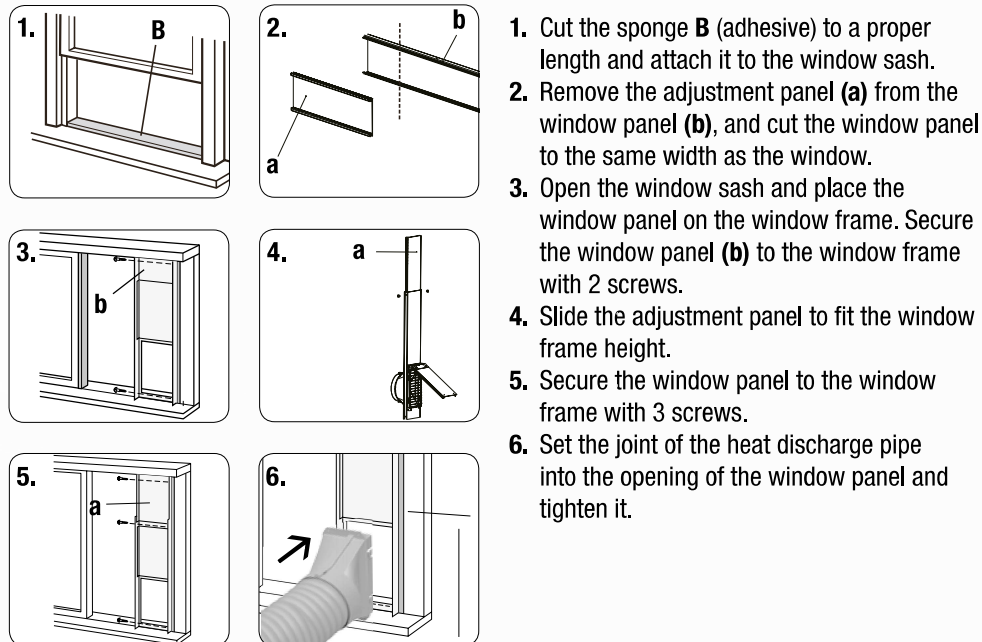

Installation in a sliding sash window of 378.4" (950 mm) to 56.7" (1440 mm) inner width inclusive

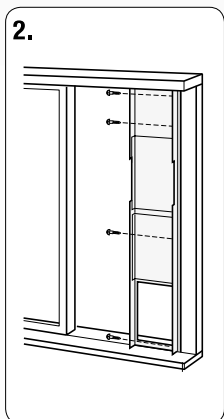
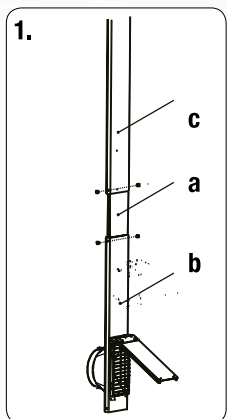

1. Attach the extension panel (c) to the adjustment panel with the screws (d).
2. Open the window sash and place the window panel (b) on the window frame. Slide the adjustment (a) and extension panels (c) to fit the window frame height. Secure the window panel to the window frame with 4 screws.

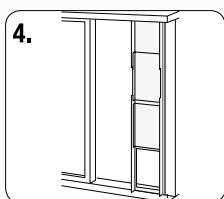
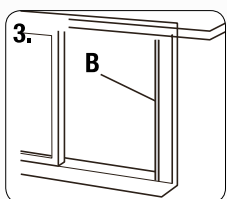

3. Cut the sponge B to a proper length and attach it to the window sash.
4. Close the window securely against the window panel.

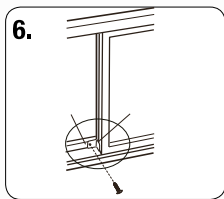
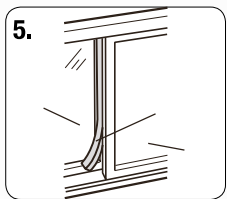

5. Cut the sponge A to a proper length and seal the gap between left side of inner window sash and outer window sash.
6. Fix the inner window with window bracket and screw, so that it can not slide horizontally.

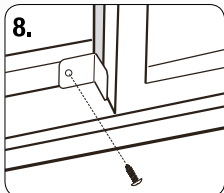
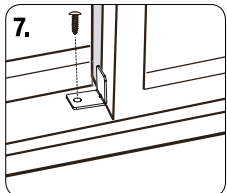

7. Plastic window frame.
8. Wooden window frame.